



J.L.Pinder And Sons
8-11/138 Hanbury Road
Stoke Prior
Bromsgrove
Worcestershire
B60 4JZ
01527 876438

www.jlpinderandsons.co.uk

River/Costal Cruiser – Fact Sheet

Introduction

An elegant River cruiser made of steel.

Construction

This elegant vessel is built in the style of a fibreglass cruiser but has the advantage of being constructed from 5/5/4/4 mild steel.

The lines of the boat replace those of sea going sport type cruisers, this allows for a spacious four berth luxurious cabin.

The general design is 36' x 10'.

Floor Plan

The interior is finished in natural ash and a soft cream vinyl headliner. The Gallery is fully equipped with electric hob, microwave and 12 volt fridge and ample cupboards and work tops. The dinette converts in to a second twin berth and the bathroom is complete with shower, vanity unit and cassette toilet.

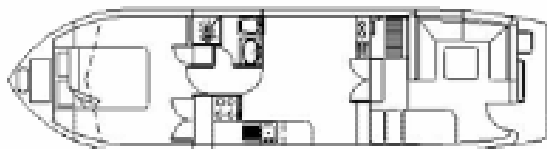
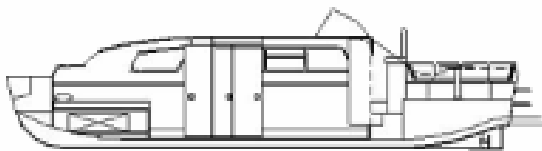

Galley



Fitted Galley

The view here is looking forward towards the bedroom. This Galley has luxury marble work-tops and all electric appliances.

Bedroom



Main Bedroom Looking forward

A double bed easily fits into the bow area of the cruiser along with a TV, dressing table and wardrobe (off to right and left of picture).

Saloon



The Saloon Looking aft.

This is half of the saloon showing a futon settee.

On the opposite side is a flat screen TV.

J.L.Pinder and sons will always consider you exact specifications for interior furnishings.

General Information

All of our boats are bespoke, and can be completed to any stage to suit your budget. We also offer complete design service for steel construction through to the technical specification and final cabin layout, using our CAD system.

Sail-Away Specification

5/5/4/4 Steel specification including all doors and hatches

50HP engine

1800 watt inverter supplying 240 volts